



Cross Keys Estates

Opening doors to your future



12 Chubb Drive
Plymouth, PL3 4TJ
Guide Price £220,000 Freehold



12 Chubb Drive, Plymouth, PL3 4TJ

Guide Price £220,000 Freehold

**** Guide Price £220,000 to £240,000 ****

Cross Keys Estates are pleased to present this delightful link detached house in a tranquil cul-de-sac on the sought-after Chubb Drive in Plymouth. The property offers a perfect blend of comfort and modern living. Built in the 1990s, this property has been immaculately presented and is ready for you to move in without any delay, as it is available with no onward chain. The home features two generous bedrooms, providing ample space for relaxation and rest. The spacious open plan sitting room and kitchen create a welcoming atmosphere, ideal for both entertaining guests and enjoying quiet evenings at home. The sleek, modern bathroom adds a touch of luxury, ensuring that your daily routines are both convenient and enjoyable.

- Fantastic Link Detached Property
- Quiet Cul-De-Sac Location
- Convenient Driveway & Garage
- Available With No Onward Chain
- Immaculately Presented Throughout
- Two Generous Bedrooms
- Spacious Open Plan Sitting Room/Kitchen
- Great Size Private Rear Garden
- Modern Fitted Kitchen & Bathroom
- Early Viewing Advised, EPC=C74



Cross Keys Estates

As one of Plymouth's leading QUALIFIED estate agents for over two decades, we are proud to have been offering our multi award winning customer service since day one. If you are currently on the market or you are thinking of putting your property on the market, why not give us a call, you will not be disappointed. 98% of our clients recommend us to their friends and family and our results, when it comes to sales, are unrivalled.

Plymouth

Plymouth, Britain's Ocean City, is one of Europe's most vibrant waterfront cities. Located in one of the most beautiful locations imaginable, Plymouth is sandwiched between the incredible South West coastline and the wild beauty of Dartmoor National Park. Plymouth is 37 miles south-west of Exeter and 190 miles west-south-west of London, between the mouths of the rivers Plym to the east and Tamar to the west where they join Plymouth Sound to form the boundary with Cornwall, it is also home to one of the most natural harbours in the world. To the North of Plymouth is Dartmoor National Park, extending to over 300 square miles, which provides excellent recreational facilities.

The city is home to more than 260,000 people, making it the 30th most populated city in the United Kingdom and the second-largest city in the South West, after Bristol and has a full range of shopping, educational and sporting facilities. There is mainline train service to London (Paddington) and to Penzance in West Cornwall.

There's everything that you would expect to find in a cool, cultural city, with great shopping, arts and entertainment. But there's also hundreds of years of history to uncover, from Sir Francis Drake and the Spanish Armada to the Mayflower sailing in 1620, to a city rebuilt following the Blitz during World War II. With easy access to Exeter and its International Airport and a mainline train station giving direct access to London and a ferry port offering sea crossings to both France and Spain.

Plymouth is governed locally by Plymouth City Council and is represented nationally by three MPs. Plymouth's economy remains strongly influenced by shipbuilding and seafaring including ferry links to Brittany and Spain, but has tended toward a university economy since the early 2000's. It has the largest operational naval base in Western Europe – HMNB Devonport.

Milehouse

Milehouse is a late Victorian and 1930s suburb of Plymouth. Formerly it was famous for the site of Outland House, the large family home of Robert Falcon Scott, who led the tragic British expedition to the South Pole. The area borders Plymouth's huge Central Park and is adjacent to Home Park, the ground of Plymouth Argyle football club. It is a reputable area with good facilities and is convenient to the city centre, the nightlife zones, the parkland and the main road in and out of town. The area is held in high regard by young and old families alike, due to its proximity to amenities such as the Britannia (Wetherspoons pub), Home Park, Life Centre and is a perfect location for those that commute both into town, northbound to Derriford Hospital and the science and business parks via the A38 dual carriageway.

More Property Information

Outside, you will find a great-sized private rear garden, perfect for outdoor activities, gardening, or simply unwinding in the fresh air. The property also boasts a convenient driveway with parking for two vehicles, making it easy for you and your guests to come and go.

This charming residence is not only a wonderful place to call home but also offers a fantastic opportunity for those looking to settle in a peaceful yet accessible area of Plymouth. Ideal for first-time buyers. With its attractive features and prime location, this property is sure to appeal to a variety of buyers. Don't miss the chance to make this lovely house your new home.

Entrance Way

Hallway

Living Room

19'5" x 6'7" (5.92m x 2.00m)

Kitchen

Landing

Primary Bedroom

8'2" x 11'4" (2.49m x 3.46m)

Bathroom

Bedroom 2

10'11" x 7'10" (3.33m x 2.38m)

Garden

Garage

Cross Keys Lettings Department

Cross Keys Estates also offer a professional, ARLA accredited Lettings and Management Service. If you are considering renting your property in order to purchase, are looking at buy to let or would like a free review of your current portfolio then please call our director Jack who is a fully qualified and award-winning letting agent on 01752 500018

Financial Services

Cross Keys Estates are proud to work in partnership with Peter Nixon Financial Services, our whole of market mortgage specialists. With over 18 years industry experience, they are able to source the very best deal to meet their customers circumstances. Offering professional and friendly advice on residential and investment mortgages. Please get in touch to arrange a free, no obligation appointment to see how they can help you. Tel. 01752 255905, Email. sarah.millman@pn-fs.co.uk

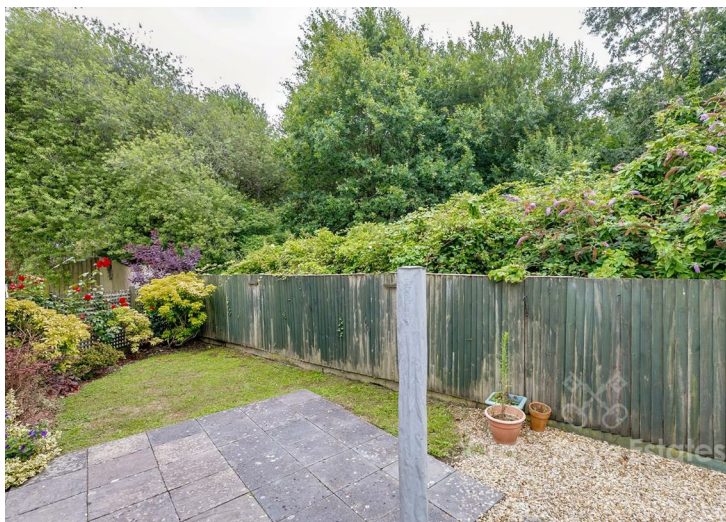

Ground Floor

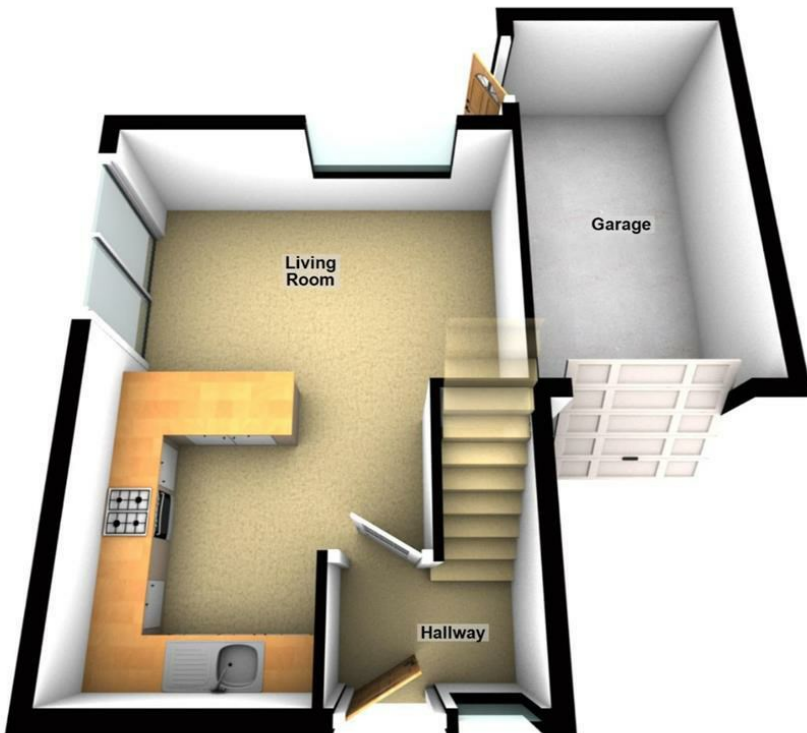

First Floor

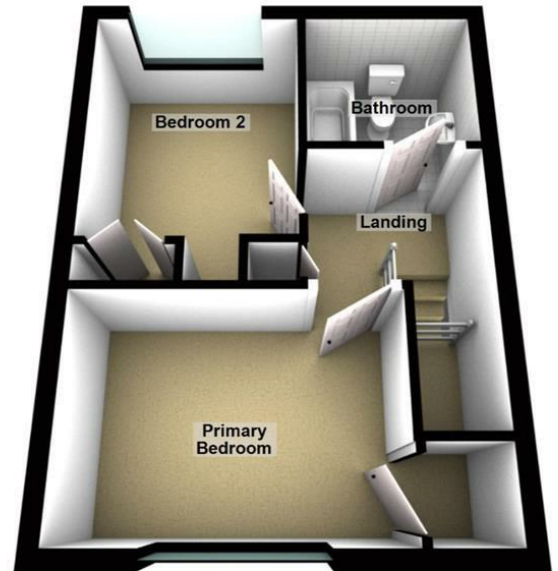

Cross Keys Estates
 Residential Sales & Lettings

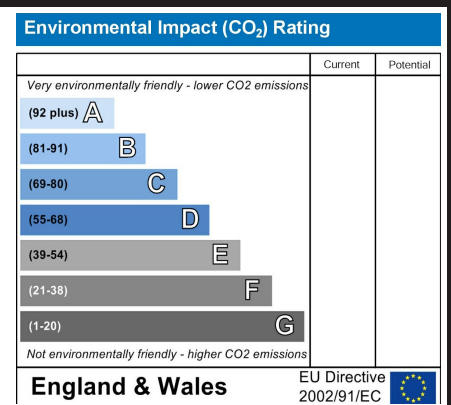
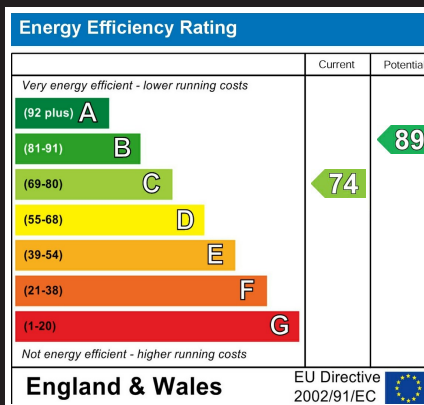
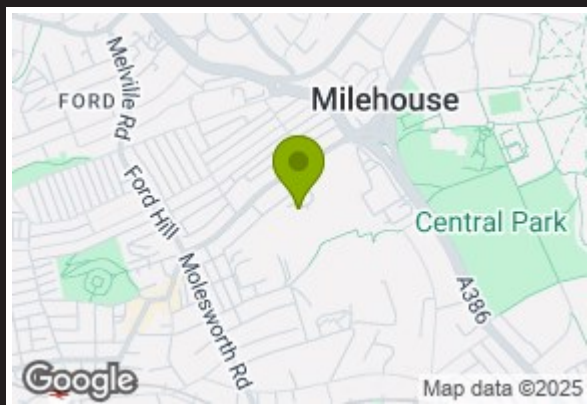

VIEWINGS AND NEGOTIATIONS Strictly through the vendors agents, Cross Keys Estates MONEY LAUNDERING REGULATION 2003 AND PROCEEDS OF CRIME ACT 2002 Cross Keys Estates are fully committed to complying with The Money Laundering Regulations that have been introduced by the government. These regulations apply to everyone buying or selling a property, including companies, businesses and individuals within the United Kingdom or abroad. Should you either purchase or sell a property through this estate agents we will ask for information from you regarding your identity and proof of residence. We would ask for you to co-operate fully to ensure there is no delay in the sales/purchase process. IMPORTANT: we would like to inform prospective purchasers that these sales particulars have been prepared as a general guide only. A detailed survey has not been carried out, nor the services, appliances and fittings tested. Room sizes should not be relied upon for furnishing purposes and are approximate. If floor plans are included, they are for guidance only and illustration purposes only and may not be to scale. If there are any important matters likely to affect your decision to buy, please contact us before viewing the property.